

LV 4005

## Miniature Ball Valve

Polished Chrome Plated Finish, BSPP Female x Male, Reduced Bore, with Screwdriver Slot

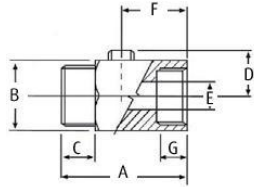

### Pressure/Temperature Ratings

Working Pressure	PN16
Temperature	-10°C to 90°C

### Material List

Body	Brass, Nickel Plated
Sleeve	Brass
Ball	Brass, Nickel Plated
Seats	PTFE
Stem O-ring	NBR
Handle	Glass Fibre Reinforced Nylon

### Reduced Bore

#### Dimensions in mm

DN	G	C	A	E	B	D	F	Kg
1/8"	9	9	39	6	21	12.5	18	0.08
1/4"	9	9	39	8	21	12.5	18	0.07
3/8"	9	9	40	8	21	12.5	21	0.07
1/2"	10.5	10.5	45	10	25	14.5	24	0.10
3/4"	13.5	13.5	51	12	30	17.0	27	0.17